

# LUMACORE ACCENT SPOT LIGHT

## 1536TXB-LMA27K

### 12V VARIABLE OUTPUT LED 2700K SPOT LIGHT

Accentuate your home's architecture and highlight your landscape's natural beauty with a warm ambient glow. Hinkley's Variable Output LumaCORE™ LED Accent Lighting Systems are expertly designed to withstand the elements and provide complete control over wattage and beam spread.

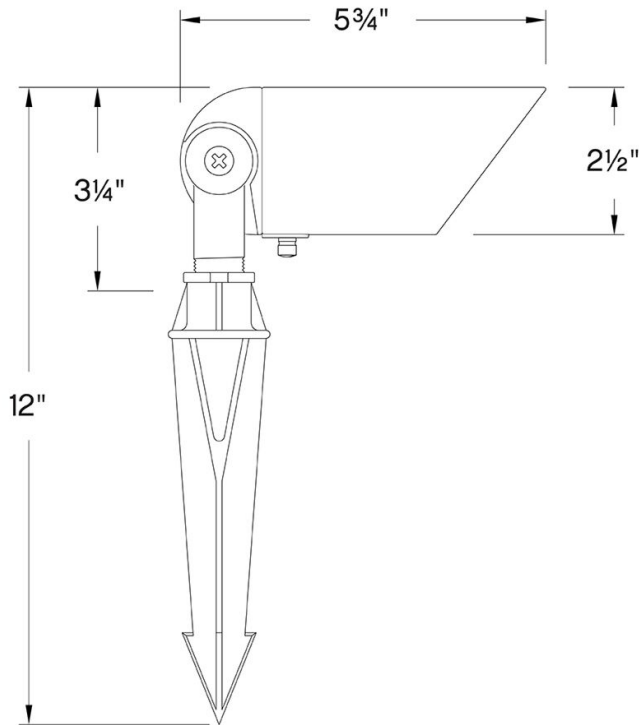

| DETAILS   |                |
|-----------|----------------|
| FINISH:   | Textured Brown |
| MATERIAL: | Aluminum       |
| GLASS:    | Clear Lens     |
| DIMMABLE: | No             |

| DIMENSIONS |      |
|------------|------|
| WIDTH:     | 5.8" |
| HEIGHT:    | 3.3" |
| DEPTH:     | 2.5  |
| WEIGHT:    | 1lb  |

| LIGHT SOURCE              |  |
|---------------------------|--|
| LIGHT SOURCE:             | LumaCore                               |
| LED NAME:                 | 27G4SE-12W                             |
| WATTAGE:                  | 12w, 8w, 5w, 3w LumaCore LED *Included |
| VOLTAGE:                  | 12v                                    |
| VOLT AMPS:                | 12.4, 7.8, 5.3, 3.2                    |
| LUMENS:                   | 750, 475, 350, 260                     |
| CRI:                      | 80                                     |
| INCANDESCENT EQUIVALENCY: | 1 x 60w, 45w, 35w, 25w                 |
| DIMMABLE:                 | No                                     |
| TRANSFORMER REQUIRED:     | Yes                                    |

| MOUNTING   |         |
|------------|---------|
| LEAD WIRE: | 1 X 18" |

| SHIPPING       |      |
|----------------|------|
| CARTON LENGTH: | 11.5 |
| CARTON WIDTH:  | 4.9  |
| CARTON HEIGHT: | 2.8  |
| CARTON WEIGHT: | 1.1  |



#### PRODUCT DETAILS:

- LumaCore Series products carry a lifetime limited warranty
- Incorporates CREE LEDs with application performance tested by CREE
- Suitable for use in wet (outdoor direct rain) locations as defined by NEC and CEC. Meets United States UL Underwriters Laboratories & CSA Canadian Standards Association Product Safety Standards
- Wattage settings includes: 3W (260 Lumens), 5W (350 Lumens), 8W (475 Lumens), 12W (750 Lumens)
- Photometrics based off engine photometrics.
- Classic lines and heritage details complement traditional architecture
- Three lens options offer versatility in beam spread via an easy to remove and insert assembly - includes: 20° Spot, 40° Flood, 60° Flood
- For more information on how to control your landscape lighting via the Hinkley Home Automation App, [click here](#).

# HINKLEY

HINKLEY  
33000 Pin Oak Parkway  
Avon Lake, OH 44012

PHONE: (440) 653-5500  
Toll Free: 1 (800) 446-5539

[hinkley.com](http://hinkley.com)