

HOVER

900752FMW-LWD

HOVER 52" LED SMART FAN

| DETAILS | |
|---------------|-------------|
| FAN FINISH: | Matte White |
| GLASS: | Etched Opal |
| BLADE COUNT: | 3 |
| SLOPE DEGREE: | 23 |

| DIMENSIONS | |
|------------|-------|
| WIDTH: | 52" |
| HEIGHT: | 17.3" |

| LIGHT SOURCE | |
|--------------|-----------|
| LED NAME: | EL16W2835 |
| VOLTAGE: | 120v |
| LUMENS: | 1320 |
| CRI: | 90 |

| MOUNTING | |
|------------|---------|
| CANOPY: | 6" Dia. |
| LEAD WIRE: | 1 x 76" |

| SHIPPING | |
|----------------|------|
| CARTON LENGTH: | 9.5 |
| CARTON WIDTH: | 10.5 |
| CARTON HEIGHT: | 19 |



Clean and sleek, Hover is a stunning modern upgrade for any project. Available in Brushed Nickel, Graphite, Matte White or Matte Black, Hover comes equipped with integrated LED lighting and DC motor technology to deliver excellent energy efficiency. Hover is impressively designed to be used for both indoor and outdoor spaces.

PRODUCT DETAILS:

- Fan Control included, HIRO Control - 6 Speed Reversing
- For more information on how to control your ceiling fan via the Hinkley Home Automation App, [click here](#).
- This item may be hung on a sloped ceiling
- Suitable for use in wet (outdoor direct rain) locations as defined by NEC and CEC. Meets United States UL Underwriters Laboratories & CSA Canadian Standards Association Product Safety Standards
- Bold silhouette with dramatic details creates a modern statement
- WiFi compatible with included fan control
- LED components carry a 5-year limited warranty
- This item includes a 6" down rod. Other various lengths of down rods are available and sold separately to customize the installation height.

HINKLEY

HINKLEY
33000 Pin Oak Parkway
Avon Lake, OH 44012

PHONE: (440) 653-5500
Toll Free: 1 (800) 446-5539

hinkley.com

HOVER 52" LED SMART FAN

900752FMW-LWD

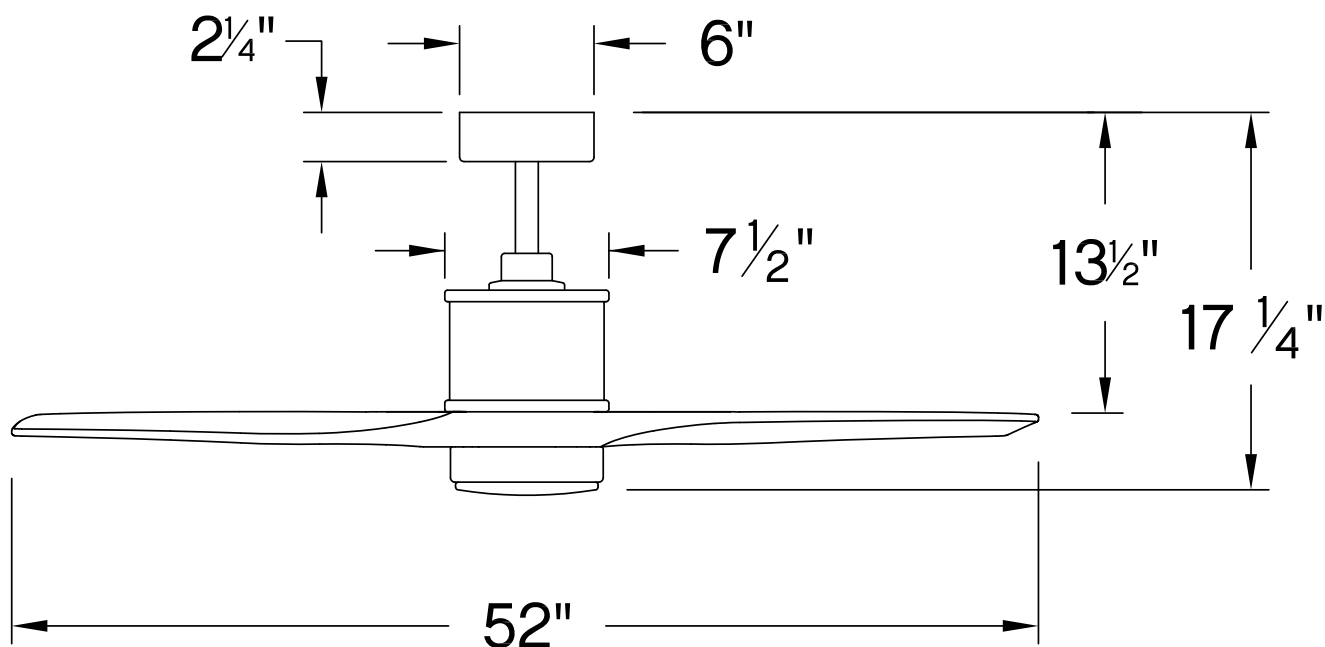

| PERFORMANCE SPECIFICATIONS | STANDARD | |
|----------------------------|------------|---------------|
| | HIGH SPEED | AVERAGE SPEED |
| Airflow | 5753 | 3713 |
| EnergyUse | 18.3 | 12 |
| EnergyCost | 5 | 3 |
| Efficiency | 314 | 311 |
| AMPS | 0.28 | 0.17 |
| RPMS | 169 | 108 |

AVERAGE PERFORMANCE AND ENERGY INFORMATION

ENERGYGUIDE

Estimated
Yearly Energy Cost
\$3

\$3 | | | **\$34**

Cost Range of Similar Models (19" – 84")

- Based on 12 cents per kWh and 6.4 hours use per day
- **Your cost depends on rates and use**
- Energy Use: 12 Watts

All estimates based on typical use, excluding lights

Airflow

3,713

Cubic Feet Per Minute

- The higher the airflow, the more air the fan will move
- Airflow Efficiency: 311 Cubic Feet Per Minute Per Watt

ftc.gov/energy

Airflow Shown is a Weighted Average of High and Low Cubic Feet per Minute Based on Downrod

HINKLEY

HINKLEY
33000 Pin Oak Parkway
Avon Lake, OH 44012

PHONE: (440) 653-5500
Toll Free: 1 (800) 446-5539

hinkley.com