

# PRESTO

## 15774MZ

### 12V LED HARDSCAPE

Offering exceptional illumination and installation versatility, Presto Hardscape lighting features an incredibly durable, integrated, modular LED design. Its stainless-steel bracket with solid brass body and frosted, composite PC lens can be easily installed onto any masonry or wooden construction. An easily replaceable LED body can be removed and serviced without rewiring. Named after the ruggedly beautiful island off the coast of British Columbia, our Hardy Island Collection is impeccably constructed with solid cast brass to defy the harshest environments.

DETAILS	
FINISH:	Matte Bronze
MATERIAL:	Brass
GLASS:	Composite PC
DIMMABLE:	YES - WITH MLV ON TRANSFORMER PRIMARY

DIMENSIONS	
WIDTH:	7"
HEIGHT:	3.3"
WEIGHT:	1.2lb

LIGHT SOURCE	
LIGHT SOURCE:	Integrated LED
LED NAME:	L15774
WATTAGE:	2w LED *Included
VOLTAGE:	12v
VOLT AMPS:	1.9
LUMENS:	120
CRI:	82
INCANDESCENT EQUIVALENCY:	1 x 20w
DIMMABLE:	YES - WITH MLV ON TRANSFORMER PRIMARY
TRANSFORMER REQUIRED:	Yes

MOUNTING	
LEAD WIRE:	1 X 60"

SHIPPING	
CARTON LENGTH:	7.8
CARTON WIDTH:	4.3
CARTON HEIGHT:	2.3
CARTON WEIGHT:	1.3

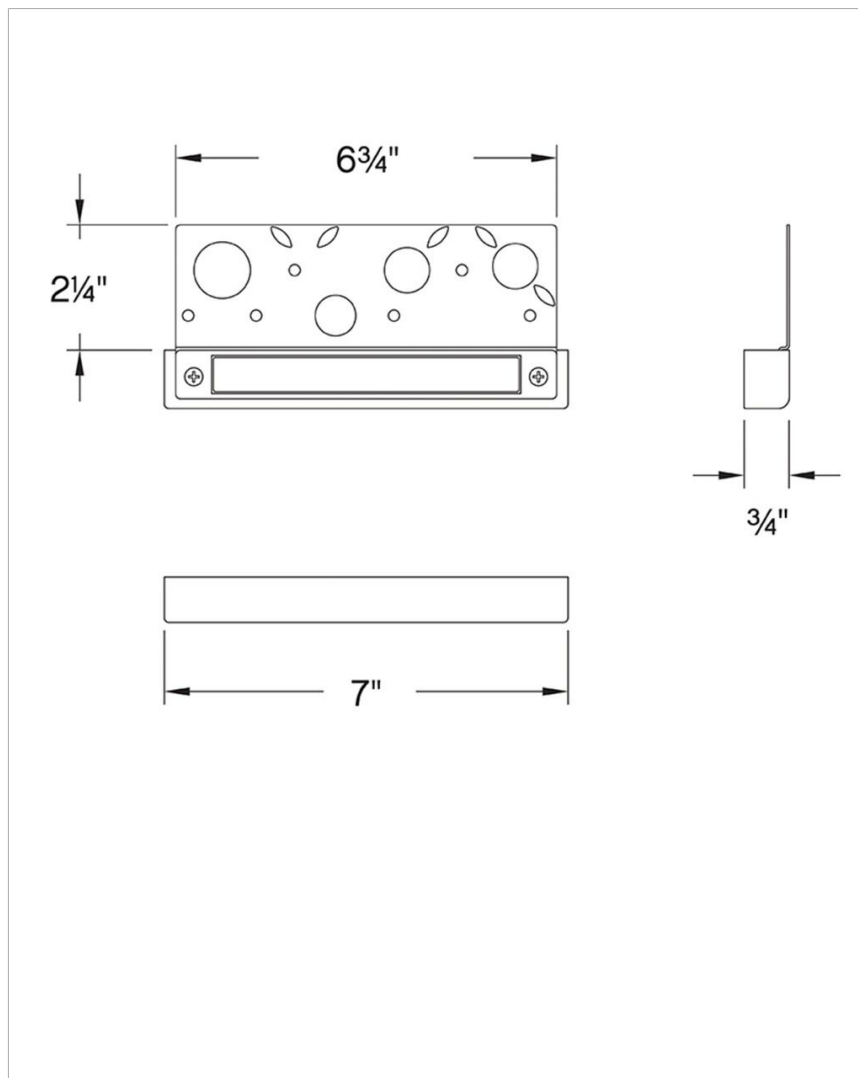

#### PRODUCT DETAILS:

- Suitable for use in wet (outdoor direct rain) locations as defined by NEC and CEC. Meets United States UL Underwriters Laboratories & CSA Canadian Standards Association Product Safety Standards
- A wiring kit is supplied
- For more information on how to control your landscape lighting via the Hinkley Home Automation App, [click here](#).
- LED integrated components carry a 10-year limited warranty

# HINKLEY

HINKLEY  
33000 Pin Oak Parkway  
Avon Lake, OH 44012

PHONE: (440) 653-5500  
Toll Free: 1 (800) 446-5539

[hinkley.com](http://hinkley.com)