

# ATOM

906030FMW-LDA

ATOM 30" LED FAN

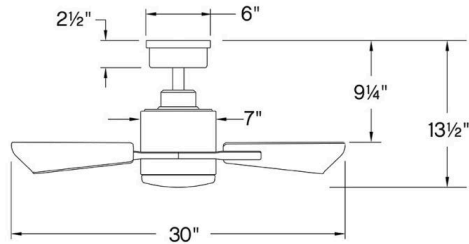

DETAILS	
FAN FINISH:	Matte White
GLASS:	Etched Opal
BLADE COUNT:	3
SLOPE DEGREE:	20

DIMENSIONS	
WIDTH:	30"
HEIGHT:	13.3"

LIGHT SOURCE	
LED NAME:	EL16W2835
VOLTAGE:	120v
LUMENS:	1320
CRI:	90

MOUNTING	
CANOPY:	6" Dia.
LEAD WIRE:	1 X 76"

SHIPPING	
CARTON LENGTH:	17.4
CARTON WIDTH:	16.4
CARTON HEIGHT:	9.5

Part of the Regency Series, Atom's compact modern profile complements functionality with classic finishes to perfectly accentuate smaller spaces. Its damp-rated design is suitable for both interior and covered outdoor areas. Dimmable Integrated LEDs emit warm, even light, creating a comfortable atmosphere. Operated by the HIRO control, the 3-speed AC motor can be WiFi enabled with the purchase of an additional control accessory. Atom mounts directly to its canopy or with the included downrod for dual mount capability. This will result in an overall fan height of 10" and a ceiling-to-blade height of 5 3/4".

## PRODUCT DETAILS:

- Can be hung on a sloped ceiling
- This item includes a 4.5" down rod (other lengths of down rods are available)
- Control your fan's power, light, speed, direction, and so much more from the Hinkley Home Automation app
- Light kit cover included
- Part of the Regency Series of traditional ceiling fans designed to enhance a wide variety of spaces with versatile designs and classic finishes
- Fan Control included, HIRO Control - 3 Speed Reversing
- Dual Mount design can hung directly to the canopy or with an included downrod
- LED components carry a 5-year limited warranty

# HINKLEY

HINKLEY  
33000 Pin Oak Parkway  
Avon Lake, OH 44012

PHONE: (440) 653-5500  
Toll Free: 1 (800) 446-5539

[hinkley.com](http://hinkley.com)

# ATOM 30" LED FAN

906030FMW-LDA

PERFORMANCE SPECIFICATIONS	STANDARD		DUAL MOUNT	
	HIGH SPEED	AVERAGE SPEED	HIGH SPEED	AVERAGE SPEED
Airflow	2845	2114	2314	1690
EnergyUse	54.8	36	47	30
EnergyCost	15.36	10	13.18	9
Efficiency	52	59	49.2	56
AMPS	0.46	0.34	0.43	0.32
RPMS	234	174	223	100